



WELCOME TO STRUCTURAL SYSTEMS, INC.

Corporate Office:
201 Poplar Avenue
Thurmont, MD 21788
Phone: (800) 800-7414



This pamphlet contains emergency and access information for visitors to the Thurmont, Maryland manufacturing facility located at:
201 Poplar Avenue, Thurmont, MD 21788

All Visitors must be informed of this information before entering the facility. If you are unsure of any instruction in this pamphlet, please ask our receptionist for assistance.

SAFETY STARTS HERE

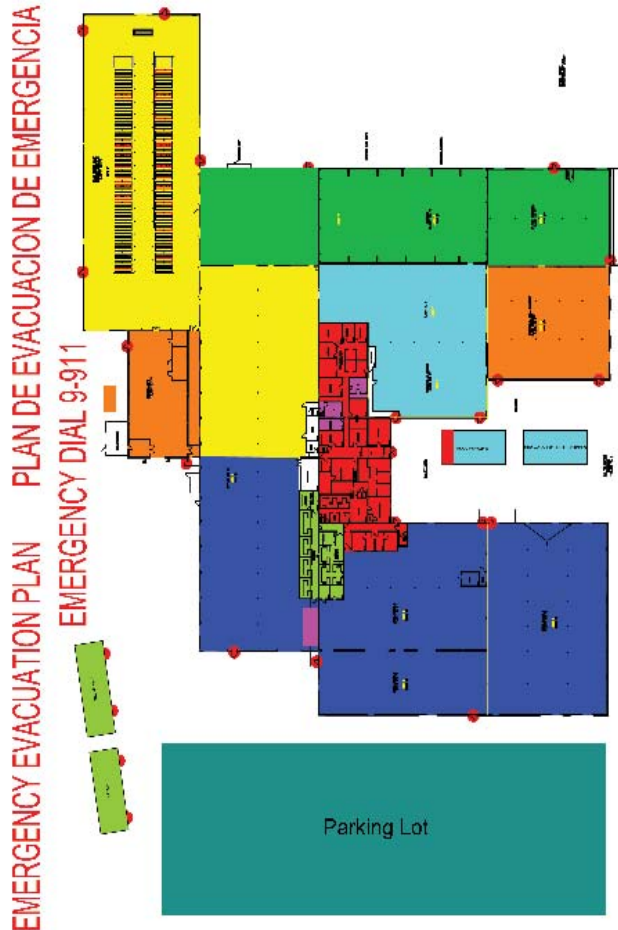

SSI Safety Philosophy:

We believe the commitment to safeguarding employees is an important objective to the success of our company.

By establishing programs such as training, employee motivation, accident prevention and compliance of all rules and regulations, we focus on eliminating incidents.

The effectiveness of our safety program requires continuous communication and involvement between all of us.

With our commitment to operate safely, effective leadership and accountability of all employees must be obtained.

Through the cooperation of all employees, it is our goal to create a safe culture and an accident-free environment.

To All Visitors:

Touring the Plant:

Pedestrians are not permitted outside the designated walkway. Please stay within the marked yellow lines. All pedestrians must use the boardwalk (Thurmont location).

Building Evacuation:

Upon hearing the alarm(s) or when you have been advised that an emergency exists and are instructed to evacuate, there are maps logistically located throughout the buildings, to assist in exiting the building. The following procedure applies:

All visitors shall exit the building swiftly (**Do Not Run**) through the nearest available exit and proceed across the street to the parking lot and report to the designated assembly area shown as **A-2** in red on the map.

Personal Protective Equipment (PPE):

The appropriate PPE, which has been approved by SSI, must be worn at all times in the manufacturing work area.

Eye Protection:

ANSI Z87.1 or (+) approved eye protection is required to be worn when entering or transiting through the manufacturing area, windows/doors warehouse and yard area.

Footwear:

The following footwear is not permitted to be worn when in the manufacturing area, window/door warehouse and yard area:

- No high heel shoes
- No open-toe shoes
- No sandals or flip-flops

Clothing:

Orange or Lime Green reflective safety vests are required to be worn when in the yard area.

Hearing Protection:

Hearing protection is recommended but optional while in the plant. In the roof truss/component saw area, hearing protection is **mandatory** for any duration over 2 hours.

First Aid Assistance

If an emergency arises requiring first-aid:

- 1. Call for a first-aider by alerting a SSI staff member.**
- 2. Remain with the injured person.**
- 3. Do not move an injured person.**

Fire/Ambulance: Dial 9-911

Police: Dial 9-911

When using an SSI phone, dial 9 prior to the actual phone number required